

CASUARINA

AWNING WINDOW



FEATURES AND BENEFITS OF THE CASUARINA AWNING WINDOW INCLUDE:

The Casuarina Awning Window is a top hung system with hollow mullion and stile sections to add strength and security.

The additional use of Q'lon seals with this system also improves energy, weather and acoustic performance.

It can also accommodate friction stays and chain winder options. Multiple bays can be added using a standard mullion.

The design includes multiple stiles to accommodate several glass thicknesses

Options available include: restricted opening, standard or barrel key locking, insect or security screens.

Frame widths available: 48mm, 75mm, and 100mm

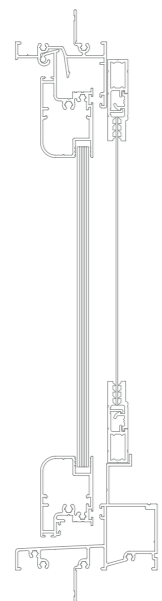

48mm FRAME

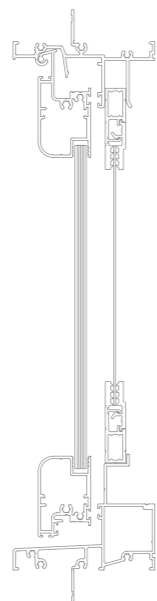

75mm FRAME

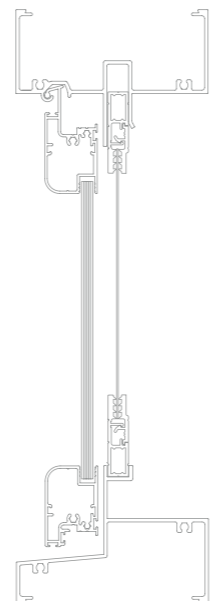

100mm FRAME

PERFORMANCE

STRUCTURAL PERFORMANCE (UP TO)

- + Serviceability Limit State Wind Pressure: 1000Pa max
- + Ultimate Limit State Wind Pressure: 3500Pa max
- + Water Penetration Resistance Pressure: 1000Pa max

MAXIMUM RECOMMENDED SIZE (UP TO)

- + Height: 1550mm
- + Height with low light: 2750mm
- + Width: 1200mm (sash width)

GLAZING MAXIMUM THICKNESS (UP TO)

- + Single Glazed: 6.76mm
- + Double Glazed: 22mm

ACOUSTICS (UP TO)

- + 48mm Awning Window: RW (C.Ctr): 32 (0-1)
- + 1016mm Awning Window: RW (C.Ctr): 35 (-1-3)

48MM SINGLE GLAZED - TOTAL WINDOW AFRC

	Uw	SHGC	T _w	Air Inf
WAS-011-05 5mm Clear	6.4	0.62	0.65	0.3
WAS-011-04 4mm Grey	6.4	0.49	0.40	0.3
WAS-011-15 6.38mm ComfortPlus Clear	4.7	0.52	0.60	0.3

48MM DOUBLE GLAZED - TOTAL WINDOW AFRC

	Uw	SHGC	T _w	Air Inf
WAS-015-05 5mm Clear/ 12mm Argon / 5mm Clear	3.9	0.54	0.57	0
WAS-015-07 4mm Clear/ 12mm Argon / 6mm EnergyTech	3.3	0.53	0.53	0
WAS-015-20 6.38mm ComfortPlus Clear / 12mm Argon/ 4mm Clear	3.3	0.46	0.53	0

CONFIGURATIONS - VIEW FROM OUTSIDE

